

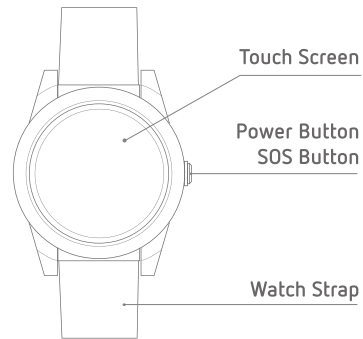

CARE
CONNECT
PROTECT

1 Getting To Know Your Watch

– Front



– Back

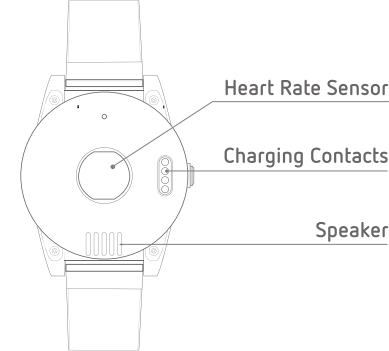

– Side

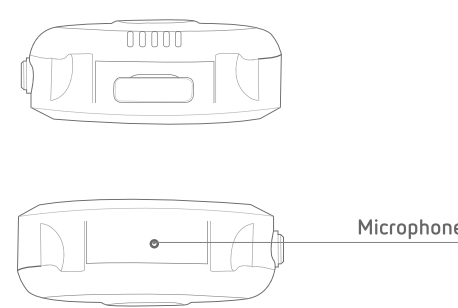

2 Accessories

USB Cable



Watch Strap



Charging Base



User Manual



3 Charging your Watch

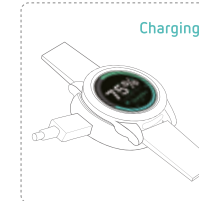
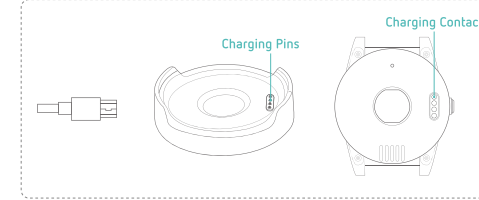

- Connect the USB cable from charging base to the AC adaptor.
- Place the watch onto the charging base correctly, the screen will illuminate and show that charging has started.
- Please charge the battery daily for around 2 hours or when battery is low.

TIP The watch battery is not removable. If powered off, the watch may not show that it is charging immediately. Please charge it every day to ensure that the watch can work continuously.

4 Functions and Basic Settings

When the watch is turned on, slide your finger leftwards or rightwards on the screen to view all the available functions. The screen displays the Watch Face, Heart Rate, Steps and Settings.



On the watch face, you can see time, date, heart rate (if available) and steps.

TEDALERT

TED Alert UK 59 High Street,
Maidstone, Kent, ME14 1SR
Email: info@tedalertuk.co.uk
Tel: 0333 7898 999
Web: tedalertuk.co.uk

5 Heart Rate Measurement



- Wear the watch on your wrist and click heart rate, after several seconds measuring, the screen will display your heart rate BPM (Beats Per Minute).

6 Activating an SOS Alarm

There are two ways to activate an SOS alarm.

- 1 Press and hold the side button for 3 seconds until you feel the watch vibrate.



- 2 Or, when the screen is on, press and hold the screen for 3 seconds until you feel the watch vibrate.



- After the SOS alarm is activated, you will get 3 short beeps to indicate that the alarm has successfully triggered

7 Getting a GPS fix

To get an initial GPS fix, go outdoors or near a window so the watch can get a fix on the satellites. This could take few minutes depending on your environment.

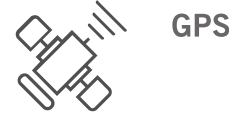

GPS

TIP GPS functionality may be unavailable or inaccurate in some locations (for example inside buildings, near tall buildings or other tall features or underground).

- The watch also provides other means of positioning the device. This is handled automatically when GPS is unavailable.
- The charging base provides out of home information in addition to optimizing watch battery life.
- Please note that the no GPS tracking service is not 100% accurate, it can only be used to approximate your location.

8 Powering off

- 1 Go into the setting menu by scrolling leftwards and press on 'Settings'.



- 2 Scroll all the way down and press 'Power off'.



- 3 Press the red V to turn the device off. X cancels the operation. After the device has been turned off press and hold the button for 3 seconds to turn it on.

NOTE: All services are unavailable until you turn the device on again.

9 General Specifications

- 1 Dimension: 47.5mm x 16.9mm/1.87in x 0.66in.
- 2 Weight: 65g/2.29oz.
- 3 Battery: Rechargeable, 3.7V,580mAh.
- 4 Charging voltage: 5V DC.
- 5 Waterproof: IPX8.
- 6 4 locating technologies: GPS, BLE, Wi-Fi, GSM.

TIP Please comply with these instructions to extend the watch life:

- Don't use or store the watch in a hostile environment. Always keep the watch and its accessories dry.
- Don't drop, shake or knock the watch, rough handling can break it.
- Clean the watch with a piece of dry cloth. Don't clean in chemicals or detergents.
- Don't disassemble or refit the watch as it will void your warranty.
- Using other batteries will void the warranty and are considered unsafe.
- Please turn the watch off when in an area where mobile communication is restricted or banned.

TEDALERT



USER
MANUAL

